

OUR SCHOOL INTO THE FUTURE



WAHROONGA
ADVENTIST SCHOOL

Nurture for today • Learning for tomorrow • Character for eternity

FUTURE DIRECTIONS

Wahroonga Adventist School is excited to be expanding into a full Prep to Year 12 School.

Classes currently run from Prep to Year 11, and the School is drawing on its 115 year history and the expertise of 48 Australian Adventist schools as it progresses its first students to Year 12.

At the same time, the School is continuing to develop a state of the art campus that will support new ways of learning.

Our new campus will structure the School as three small schools in one as part of our nurturing, individualised approach.



THREE SCHOOLS IN ONE AND PLENTY OF PLAY SPACES

We want each student to feel proud of, and have a sense of ownership over the School they belong to.

An exciting variety of new play spaces have been created for students of all ages to enjoy.



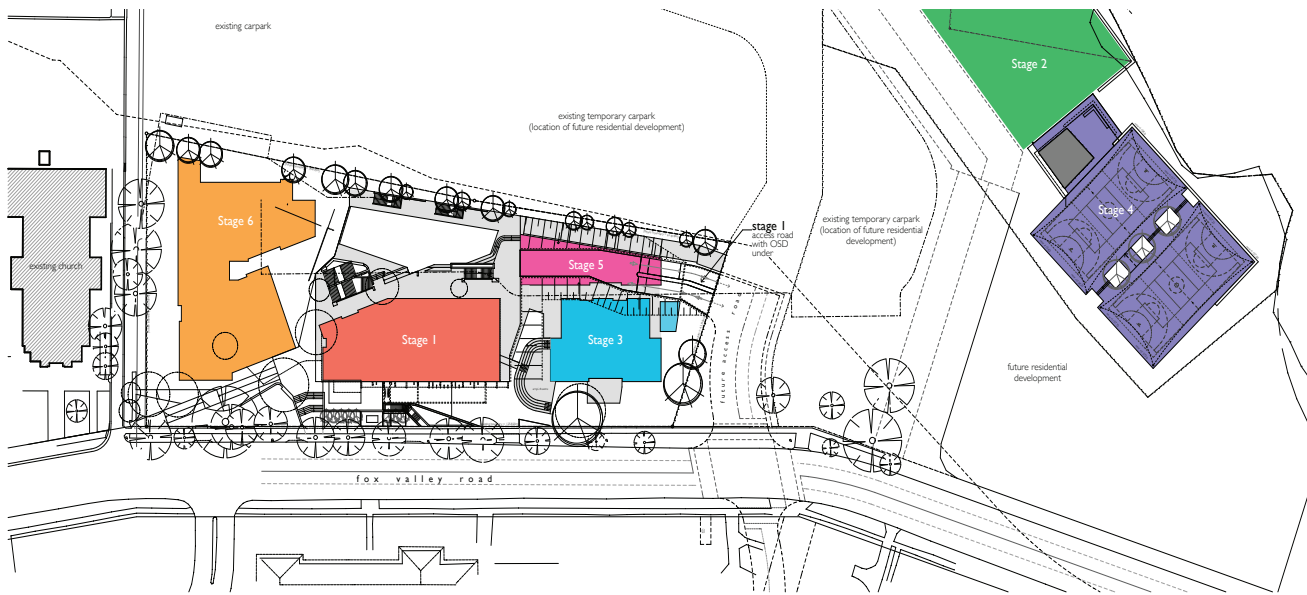

Our new campus will structure the School as three small schools in one as part of our nurturing, individualised approach.

STAGE ONE

Middle School (Years 5 to 8) Developing
Years *Opened 2017*

- Specialist learning areas
- Science labs
- Music and Art studios
- Design and Technology Lab
- Hospitality Kitchen
- Computer Lab
- General learning areas
- Outdoor play area

STAGE TWO

New Oval
Opened 2017

- Grassed play space for team games
- Fast zone for running



STAGE THREE

Junior School (Prep to Year 4) Foundation Years
Opened January 2019

- Contemporary teaching and learning spaces
- Rooftop play space:
 - For Junior students, an imagination and 'play construction zone' with 'big toys' like car mats and cars, connect four, dominoes, chess and table tennis
 - When in use by Middle and Senior School students, this space becomes a gathering zone for social circles, mini student led music concerts, with the indoor music pod opening into this area, and garden style games
- At the front of the Junior School:
 - New adventure trail with rope play equipment, monkey bars and balance equipment
 - Grassed area for running and ball games
 - Inside-out play area with smaller toys
 - Slow down trail with interactive areas
 - Calm space of sand and water play
 - Amphitheatre with a handball and gathering area, and small synthetic grass slope for sitting and imagination play



STAGE FOUR A & B

Junior School (Prep to Year 4)

A : Opening Term 3 2020

- Large ship playgroup with shade cloth

B : Opening Term 2 2020

- Basketball courts
- Toilet block and storage area



STAGE FIVE

Junior School (Prep to Year 4)
Opened 2019

- Computer Lab
- Music Lab
- Special education and learning support spaces
- Oosh Care
- Junior School office and staffroom



STAGE SIX

Senior School (Years 9 to 12) Future Leaders
Timeline to be determined

- 10 adaptable classrooms with supporting technology
- Office space
- Auditorium/multipurpose facility
- Canteen
- Uniform shop
- Library
- Study and Resource Centre

OUR SCHOOL SITS AT THE HEART OF THE WAHROONGA ESTATE



The Wahroonga Estate is a 62.4 hectare precinct designed to bring together all the essential elements of a vibrant community: healthcare, education, employment opportunities, student accommodation, residential, aged care, a church and community centre, and the natural environment.

The Wahroonga Estate is owned by the Seventh-day Adventist Church, which received planning approval of its vision for the precinct in 2010, after many years of planning and community consultation.

The next stage of work is the residential component, which includes 200 apartments across five residential buildings, varying between 4–6 storeys in height, and located on the northern side of Fox Valley Road and to the rear of our School.

The Church is seeking planning approval from the local council for the detailed design of the residential buildings. Further details are available at www.wahroongaestate.com.au.

As the vision comes to life, our School will work closely with the Church to ensure students can continue to enjoy an environment conducive to learning and that disruption to school life is minimal.

We have a track record of success in operating adjacent to building works and keeping children safe is paramount.



PLAY SPACES FOR TODAY

Oval adjacent to natural bushland

In just a few minutes, children are walked to the oval by supervising teachers to enjoy play time in a natural setting. Walking together to a different space provides a sense of adventure, stimulates the mind and teaches children flexibility and resilience. Here they enjoy grassed play space for team games and a fast zone for running.

Synthetic grass outdoor play area

For skipping, table tennis and informal play.

Playground for Middle School students

Featuring a climbing wall, monkey bars, flying fox and balancing beams. This is a fun way for children to get active and learn how to take play well with others.

Basketball court and handball courts

For a good workout and to advance motor skills. Students learn about teamwork, competition and what it means to show good sportsmanship.

Library

Junior and Middle School students may use the library during lunch as a quiet zone to read, play board games and play with Lego, puzzles and iPads. Students may also use the space for study or homework.



continued on back...

PLAY SPACES FOR TODAY *continued...*

Morning tea and lunch is staggered for the Junior, Middle and Senior Schools – giving all students exclusive access to play spaces when it is their turn to go outside and get active.

Students have regular supervised access to walking trails through the bushland and along Coups Creek as part of their science, geography, outdoor recreation and PDHPE lessons. This provides ongoing opportunity to enjoy the natural environment.



Secondary school students use local community facilities, including George Christie Playing Field, to play soccer, cricket, tennis, basketball, netball handball and touch football. Through interschool sport, students interact with other schools and develop social skills on and off the sports field.

WOULD YOU LIKE TO FIND OUT MORE?

For more information about anything in this brochure, or to chat about the opportunities our School offers, please contact our Principal, Michelle Streatfeild. We look forward to hearing from you.

📞 02 9487 2100

✉ info@wahroonga.adventist.edu.au

Visit www.wahroonga.adventist.edu.au